

This drawing is copyright & the property of EC Harris & must not be copied in whole or in part without their written permission. Copyright is reserved. © This drawing must not be scaled.
The Contractor is to report all dimensional discrepancies & errors to the Contract Administrator prior to construction commencing.
It is essential that this drawing is read in conjunction with all specifications/ schedule of works & that all works are included for.

SAFETY HEALTH AND ENVIRONMENTAL (SHE) INFORMATION	
	Based upon the assumption that all works will be undertaken by competent contractors working, where appropriate, to approved method statements, the designer would draw the reader's attention to the significant residual SHE risks that have not been eliminated from the designs shown on this drawing by the design process.
	CONSTRUCTION, OCCUPANCY AND DEMOLITION (List below the significant residual risks for EACH of these three phases of operation). <i>Where the designer determines that, so far as is reasonably practicable, there are no foreseeable significant residual design risks associated with that phase of operation the statement "NO FORESEEABLE SIGNIFICANT RESIDUAL DESIGN RISKS IDENTIFIED" shall be displayed (no section shall be left blank).</i>

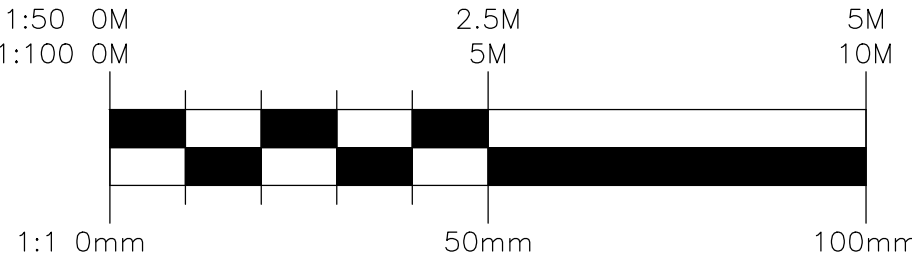

South Tyneside Council
Planning Group
Received 19/11/2013
ST/1285/13/ADV

Rev No.	Comments	Date
Client BANK OF IRELAND		
Project title OFFSITE ATM INSTALLATIONS 7 EAST STREET, WHITBURN SUNDERLAND, SR6 7BY		
Drawing title WHITBURN POST OFFICE EXISTING AND PROPOSED PLANS		
Drawing status DRAFT		
Job No. 15961101	Project co-ordinator	
Scale 1:100@A3	Date 13.03.2013	
Drawn by FB	Checked by	
Dwg. No. WB/02	Rev. No.	

EC HARRIS
BUILT ASSET
CONSULTANCY
AN  **ARCADIS COMPANY**

EC HARRIS LLP
ECHQ,
34 York Way,
London. N1 9AB
t +44 (0)20 7812 2000
f +44 (0)20 7812 2001
www.echarris.com

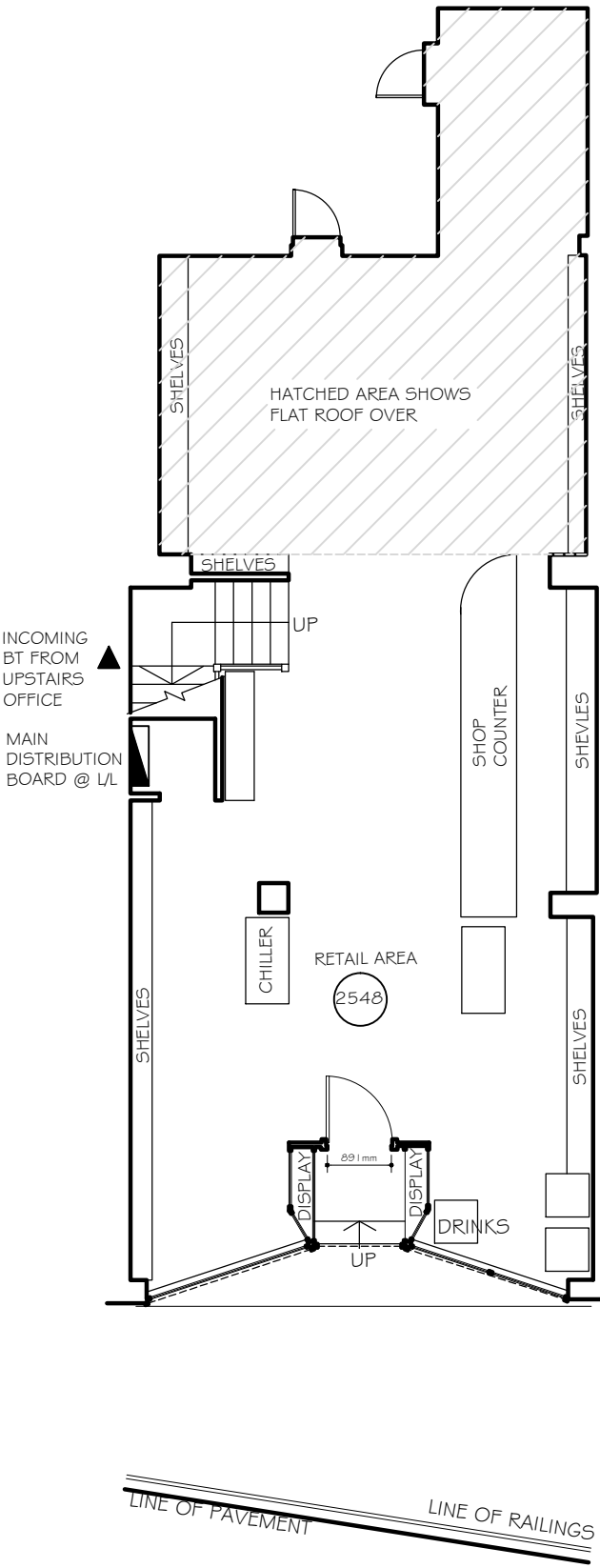

WHITBURN-2052343
EXISTING PLAN @ 1:50

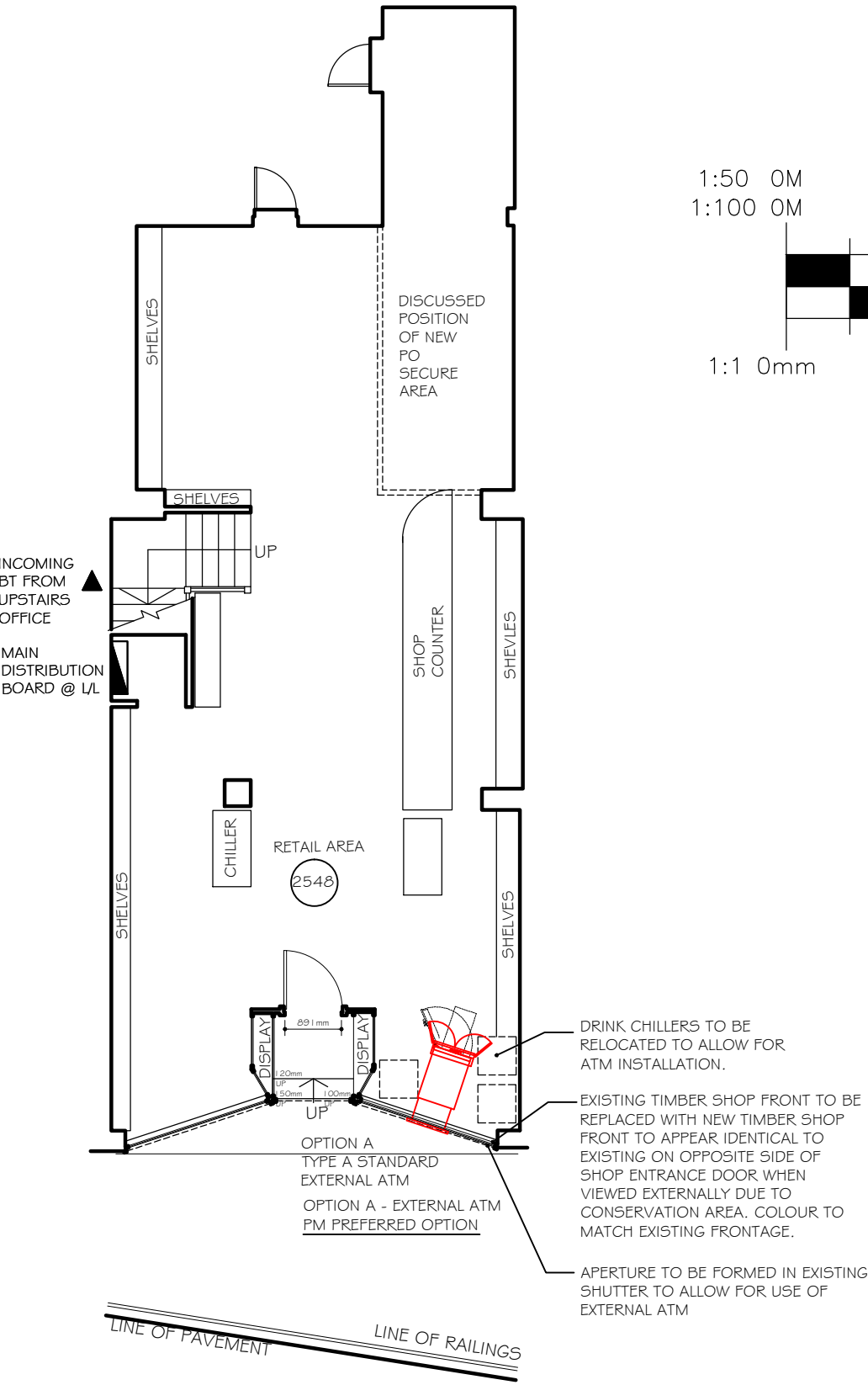

WHITBURN-2052343
PROPOSED PLAN @ 1:50